

Condensatori - Capacitors

Condensatori di rifasamento con tensione di targa 250 o 450Vac, 50Hz, temperatura di impiego -25.. + 85°C, custodia in materiale plastico auto-estinguente

Power factor corrected capacitors with plate power of 250 or 450Vac, 50Hz, temperature range -25.. + 85°C, plastic self-extinguishing casing

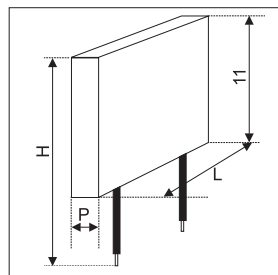

Articolo Article	μF	$\frac{L}{\text{mm}}$	$\frac{P}{\text{mm}}$	$\frac{H}{\text{mm}}$			Codice Code
N047	0,047	18	5	45	-	200	S53970 ●
N068	0,068	18	5	45	-	200	S53974 ●
N01	0,100	18	5,5	45	-	200	S53978 ●

Per illuminazione 250Vac con terminali isolati
For lighting 250Vac with insulated terminals



Articolo Article	μF	$\frac{\varnothing D}{\text{mm}}$	$\frac{L}{\text{mm}}$			Codice Code
N02	2	25	56,5	26	162	S53901
N04	4	25	56,5	26	162	S53903
N05	5	25	69,5	38	162	S53905
N06	6,3	25	69,5	52	162	S53906
N08	8	30	69,5	52	110	S53907
N10	10	30	69,5	68	110	S53908
N12	12	35	69,5	68	80	S53909
N14	14	35	69,5	88	86	S53910
N16	16	35	69,5	112	86	S53911
N18	18	35	93,5	112	86	S53913
N20	20	35	93,5	142	86	S53915
N25	25	40	94,5	142	60	S53917
N30	30	40	94,5	178	60	S53919
N35	35	45	94,5	244	50	S53921
N40	40	45	94,5	244	50	S53923
N50	50	50	94,5	322	40	S53925

Per illuminazione 400Vac
For lighting 400Vac

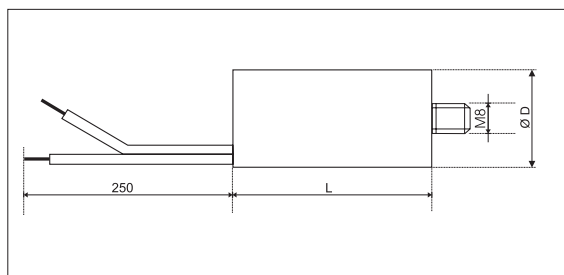

Articolo Article	μF	$\frac{\varnothing D}{\text{mm}}$	$\frac{L}{\text{mm}}$			Codice Code
N01/4	1,5	28	57	45	162	S53931
N02/4	2	28	57	45	162	S53933
N03/4	3	28	57	45	162	S53935
N04/4	4	28	57	45	162	S53937
N05/4	5	28	57	45	110	S53939
N06/4	6	28	57	45	110	S53941
N08/4	8	32	57	55	86	S53943
N10/4	10	35	57	70	86	S53945
N12/4	12	35	72	85	86	S53947
N14/4	14	40	72	100	86	S53949
N16/4	16	45	72	130	86	S53951
N18/4	18	40	95	135	60	S53953
N20/4	20	40	95	135	60	S53955
N25/4	25	45	95	160	50	S53957
N30/4	30	45	121	220	50	S53959
N40/4	40	50	121	250	44	S53960
N50/4	50	50	121	250	40	S53961

Per motori 450Vac, con connessione Faston 6,3x0,8
For motors 450Vac, with faston connection 6,3x0,8

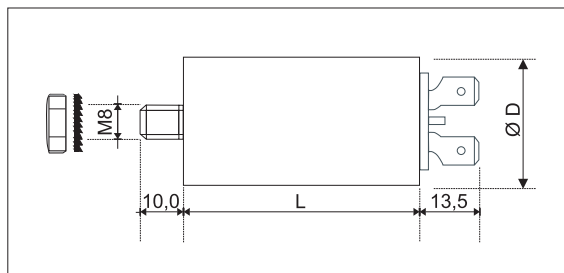

Valori di capacità diversa da quelli sopra riportati possono essere ottenuti mettendo in parallelo più condensatori (es. 60 μF = 40+20 oppure 30+30)

Different capacity values to the above here mentioned can be obtained by placing several capacitors in parallel (ex. 60 μF = 40+20 or 30+30)

